

SPEC SHEET

Universal Guardrail



GUS-EA



Features

Painted safety green/yellow for added safety and visibility

System can be easily installed in minutes by drilling onto concrete or bolting onto steel substrates

Eliminates fall hazard with our pre-engineering fall prevention system

Finishes

■ Green

■ Yellow

■ Hot Dip Galvanized

Design Specifications

Guardrail Height

42"

Available Lengths

5', 7.5', 10'

Material

ASTM rated steel

Finish

Electrostatic paint

Relevant Standards

OSHA

1910

1926

SPEC SHEET

Guardrails 56 lbs Base



GUB56

Features	
Completely non-penetrating system be installed in just minutes	
Includes 2 extended EPDM supports on both sides for better stability	
The rails slide in perfectly into the base fittings	
Includes 4 holes to drill into substrate for fixed application option	
Lightest base in the market	
Includes two convenient EPDM handles for better ergonomics	
Includes two universal toe board slots to protect personnel beneath the system	
Electrostatic painted for added safety and visibility	<div style="display: flex; gap: 10px;"> <div style="width: 15px; height: 15px; background-color: green; border: 1px solid black;"></div> GREEN </div> <div style="display: flex; gap: 10px;"> <div style="width: 15px; height: 15px; background-color: yellow; border: 1px solid black;"></div> YELLOW </div>

Design Specifications	
Weight	56 Lbs
Material	ASTM Rated Steel
Finish	Electrostatic Paint
Relevant Standards	
OSHA	1910
	1926

PATENT PENDING #63458444

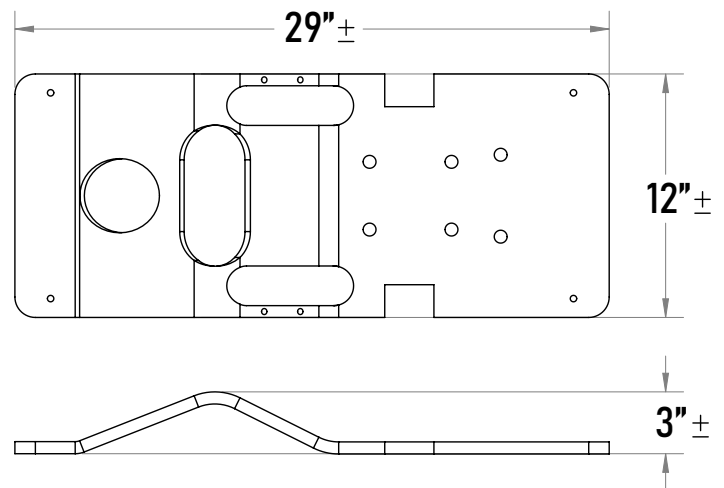

ASTM A36 15mm - 5/8"

Total Weight: 56 lbs

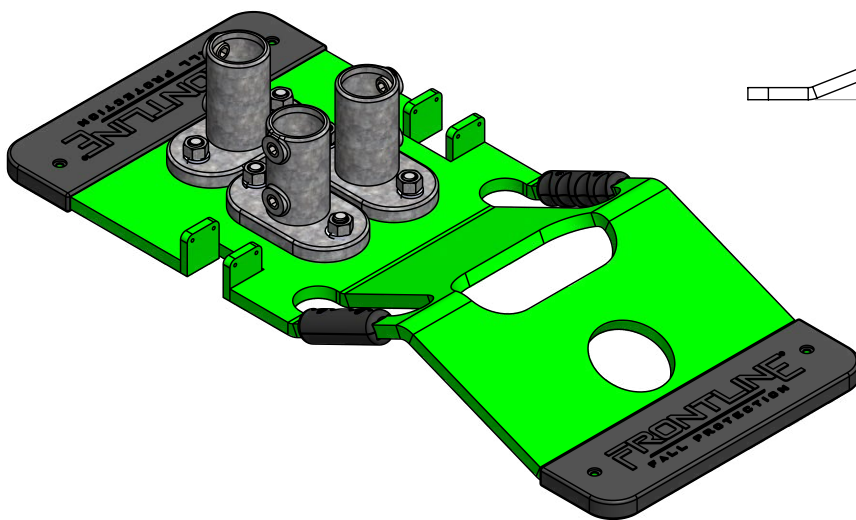

SPEC SHEET

Universal Guardrails with Bases Complete Kit



GUS



KIT INCLUDES
11 BASES
10 GUARDRAILS

PATENT
PENDING

TOTAL WEIGHT
(Including pallet)
GUS10 - 1056 lbs
GUS75 - 996 lbs
GUS05 - 806 lbs

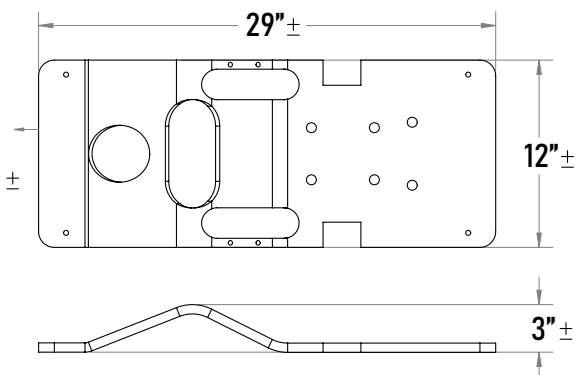

ASTM A36 15mm - 5/8"
Base Total Weight: 56 lbs

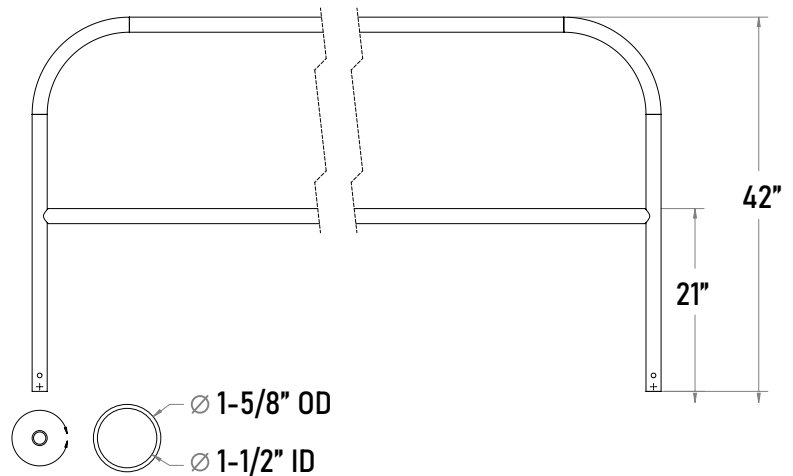

CUSTOMIZE our fall prevention system with no **extra fees!**

Add your company's logo and choose a custom color for your guardrails

- 6 Kits Minimum order
- 4-6 week lead time



www.frontlinefall.com info@frontlinefall.com
6 Lee Blvd, Malvern, PA 19355

SPEC SHEET

Universal Guardrails with Bases Complete Kit



GUS



Design Specifications	GUS10	GUS75	GUS05
Total Kit Length	100'	75'	50'
Guardrail Length	10'	7.5'	5.0'
Kit Weight	936 lbs	876 lbs	776 lbs
Guardrail Weight	32 lbs	26 lbs	16 lbs
Compliance	OSHA 1910 & 1926	OSHA 1910 & 1926	OSHA 1910 & 1926
		CAL OSHA Title 8 Section 3209	

Features	
Lightest base in the market with rubber handles on sides for better ergonomics	Includes three fittings with grub screws for a more secure and stable guardrail fit
Guardrail system can be stacked 4 pallet high	EPDM supports for better stability
System can be easily installed in just minutes	Includes two toe board slots for overhead protection



www.frontlinefall.com info@frontlinefall.com
6 Lee Blvd, Malvern, PA 19355

FRONTLINE FALL PROTECTION TEST REPORT

SCOPE OF WORKS

Data Only – Testing in reference to General Industries OSHA 1926.105(b) / 1910.29(b)

REPORT NUMBER

105226330CRT-001

ISSUE DATE

10/26/2022

PAGES

5

DOCUMENT CONTROL NUMBER

GFT-OP-10a (6-March-2017)

© 2017 INTERTEK





Total Quality. Assured.

3933 US Route 11
Cortland, New York ,USA
13045
Telephone: 607-758-6246
Facsimile: NA
www.intertek.com

TEST REPORT FOR FRONTLINE FALL PROTECTION

Report No.: 105226330CRT-001

Date: October 26, 2022

FRONTLINE FALL PROTECTION

Ph: +1 (888) 523-1795

Andres Betancourt
2023 NW 84th Ave
Miami, FL 33122
USA
andres@frontlinefall.com

Report Number..... : 105226330CRT-001

Signed Quote Number..... : QU-01306255-0

PO Number..... N/A

Name of Testing Laboratory

Preparing the Report : Intertek Testing Services NA Inc.

Test Specification:

Standard..... : N/A

Date(s) of Testing..... : 10/14/2022-10/18/2022

Product Description:

Product Type: : Guard Rail System

Brand Name: : Frontline

Model Number(s): : GUS10

Date(s) Samples Received : 10/12/2022

This report is for the exclusive use of Intertek's Client and is provided pursuant to the agreement between Intertek and its Client. Intertek's responsibility and liability are limited to the terms and conditions of the agreement. Intertek assumes no liability to any party, other than to the Client in accordance with the agreement, for any loss, expense or damage occasioned by the use of this report. Only the Client is authorized to permit copying or distribution of this report and then only in its entirety. Any use of the Intertek name or one of its marks for the sale or advertisement of the tested material, product or service must first be approved in writing by Intertek. The observations and test results in this report are relevant only to the sample tested. This report by itself does not imply that the material, product, or service is or has ever been under an Intertek certification program.

Date: October 26, 2022



SECTION 1

SUMMARY OF TESTING

TESTS COMPLETED	TEST SECTION	STATUS
Static Strength Test 200lb (890N Applied outward/downward direction any a point along top edge)	1926.105 (b)	See Results

SECTION 2

This test report concludes the work anticipated in the testing phase of your project. If there are any questions regarding this report, please contact the undersigned at 607-753-6711.

COMPLETED BY:	Steve Morey	REVIEWED BY:	Matthew Stevens
TITLE:	Technician	TITLE:	Team Leader
SIGNATURE:		SIGNATURE	
DATE	10/24/2022	DATE:	10/26/2022

Please see attached test data for detail.

SECTION 3

TESTING EQUIPMENT CALIBRATION INFORMATION

USED FOR TEST	DESCRIPTION	MANUFACTURER	CONTROL NO.	MODEL NO.	SERIAL NO.	CAL. DATE	CAL. DUE
X	Load Cell	Interface	L099	-	-	11/11/21	11/11/22
X	Tape Measure	Stanley	N1407	-	-	2/16/22	2/16/23

Date: October 26, 2022

SECTION 3

SUPPLEMENTAL TEST DATA

OSHA 1926.105 (B)	Static Strength Test for Guard Rails 200lb (890N) :			
	A. <u>Pull outward direction Hold at 200lbs.</u>			
	B. <u>Pull at downward direction Hold at 200 lbs (890N)</u>			
	C. <u>Shall not deflect to a height less than 39 inches</u>			
	Static Strength Requirements			
	Anchorage resist the test load?			
Height Maintain Greater than 39 inches?				
Downward Position				
Static Strength Requirements				
Anchorage resist the test load?				
Height Maintain Greater than 39 inches?				

SECTION 5

REVISION HISTORY

REPORT NUMBER	DATE OF REVISION	DESCRIPTION OF CHANGE:	PROJECT OWNER	REVIEWED BY
105226330CRT-001	10/24/2022	Original Report	Steve Morey	Matthew Stevens
105226330CRT-001	10/26/2022	Revised per Client Email 10/26/22	Steve Morey	Matthew Stevens

Date: October 26, 2022

SECTION 6
PHOTOGRAPHS

Client Provided Image(s)

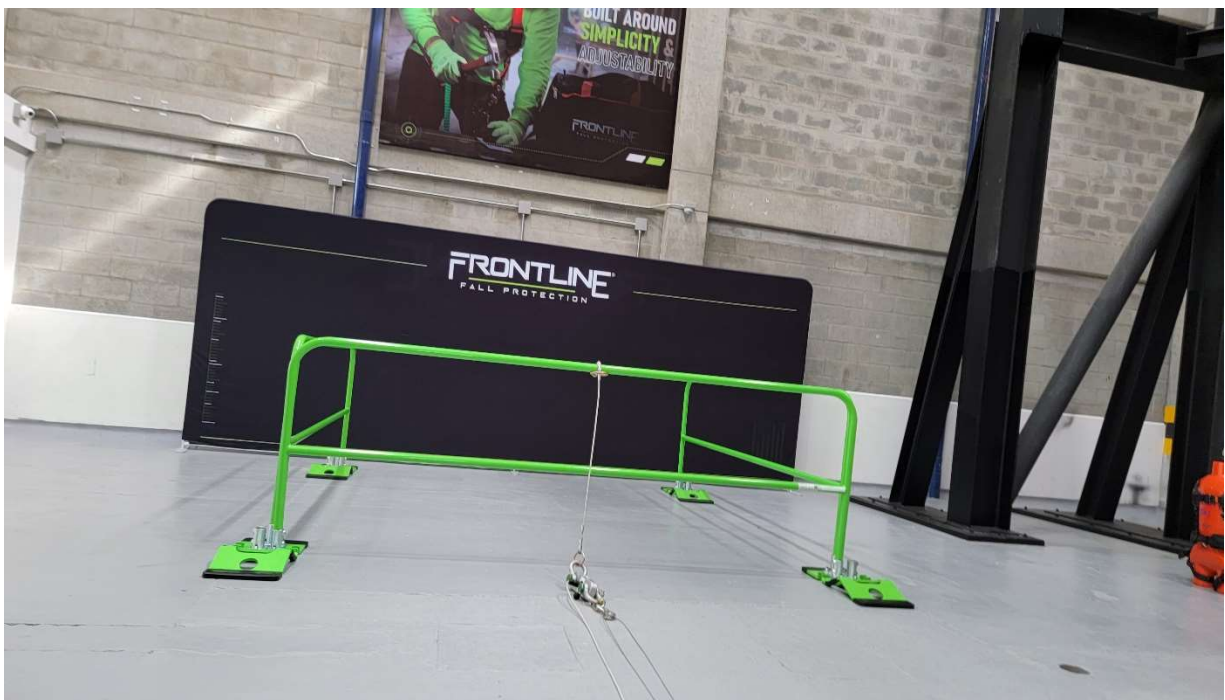

SECTION 6

PHOTOGRAPHS (Continued)

Testing Image(s)



GUARDRAIL SYSTEMS

FRONTLINE[®]
FALL PROTECTION

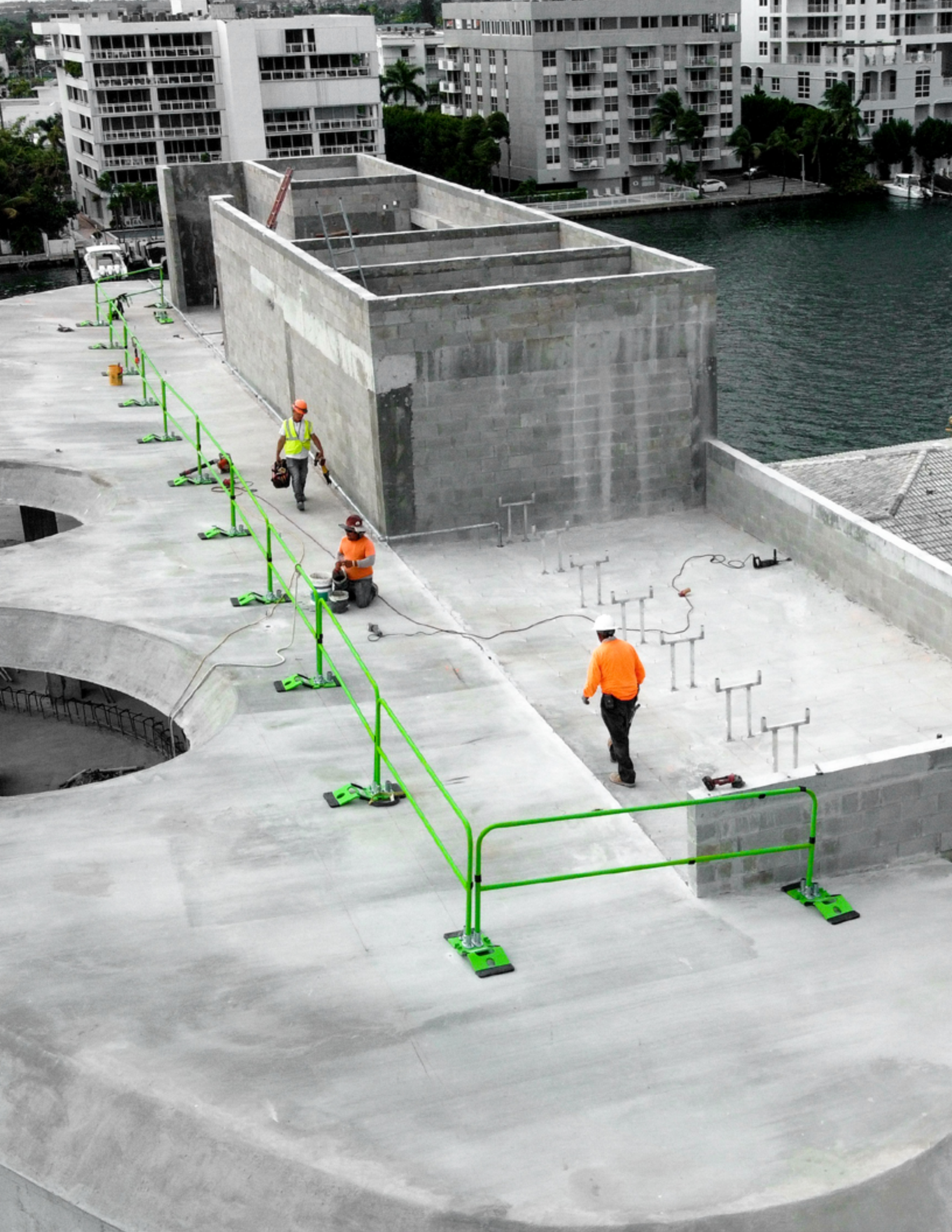

COMPLETE NON-PENETRATING FALL PREVENTION SYSTEM

The lightest and most innovative fall prevention guardrail system in the market!



KIT INCLUDES
11 Bases
10 Guardrails

AVAILABLE KIT LENGTHS
GUS10 — 100'
GUS75 — 75'



IN-HOUSE CUSTOMIZATION



**CUSTOM COLOR
UPON REQUEST**

Minimum order of 6 kits
4-6 WEEK LEAD TIME

Give your brand visibility by providing a file with your logo and desired color for your guardrails.

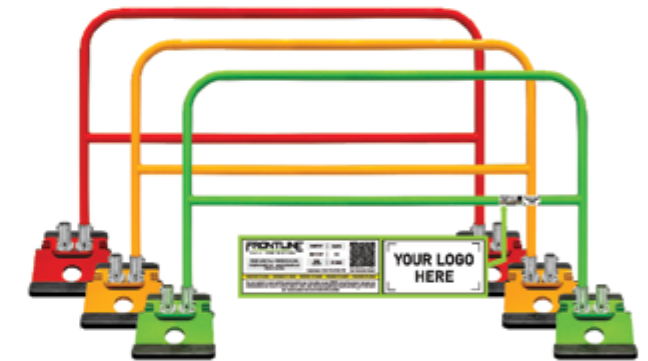

1926

1910

EPDM ERGONOMIC HANDLES

For better product handling

EPDM SUPPORTS

For better stability

PATENT PENDING
#63458444



**INCLUDES UNIVERSAL
TOE BOARD SLOTS**

To protect personnel
in lower levels

GUARDRAILS 56 LBS BASE

GUB56



The Frontline base is intended to go with our Guardrail Systems. The Frontline base is lightweight and its innovative design brings the best in class when installed with our rails and used in conjunction as a fall prevention system.

KEY FEATURES

- Bases include 2 extended EPDM supports on both sides for better stability
- Features the lightest base in the market and includes two convenient EPDM handles for better product handling and ergonomics
- Includes two universal toe board slots to protect personnel beneath the system or items from falling out of the top surface

BASE TOTAL WEIGHT

56 lbs

PATENT PENDING

#63458444

GUARDRAIL FOR CONCRETE OR STEEL SUBSTRATES

GUS

Frontline features a variety of perimeter edge protection, including non penetrating and fixed solutions for permanent installation. It's manufactured out of high strength ASTM rated steel and painted with safety green or safety yellow electrostatic paint for long lasting durability and added visibility at the workplace.



GUARDRAIL SECTIONS

10' GUS10-EA **7.5'** GUS75-EA

GUARDRAIL SYSTEM FOR FIXED APPLICATIONS

10' GUS10-FXD **7.5'** GUS75-FXD

KEY FEATURES

- Guardrails are electrostatic painted safety green or safety yellow for added safety and visibility
- System can be easily installed in minutes by drilling onto concrete or bolting onto steel substrates
- The rails slide in perfectly into the base fittings and are secured with two grub screws for best stability and to prevent loose rails
- **Available colors:** ■ Safety Green ■ Safety Yellow



Frontline Guardrail System
CAN BE STACKED 4 PALLET HIGH
for better and more efficient transportation

GUARDRAIL 5' ROLLING SWING GATE

GUG55



KEY FEATURES

- Swing gate is powder coated safety green or safety yellow for added safety and visibility
- Gate includes support wheel for ease of opening/closing gate
- Comes with built-in pin lock to secure with opposing rail quickly and securely
- Hassle free set-up, just slide into base fitting and tighten grub screws

The Frontline swing gate is uniquely designed to slide directly into any of the fittings of Frontline bases. Tighten, adjust accordingly and it's practically ready to use to give safe access and egress to workers using the Frontline guardrail systems!

Available colors: ■ Safety Green ■ Safety Yellow



TOE BOARD

GUTO10

Frontline Toe Board attachments fit perfectly into the GUS10 guardrail systems. They have end clip to slide right into the bases for a secure and snug fit to ensure nothing falls from the roof or deck onto lower level to protect personnel. It's manufactured out of high strength ASTM rated steel and painted with safety green or safety yellow electrostatic paint for long lasting durability and added visibility at the workplace.

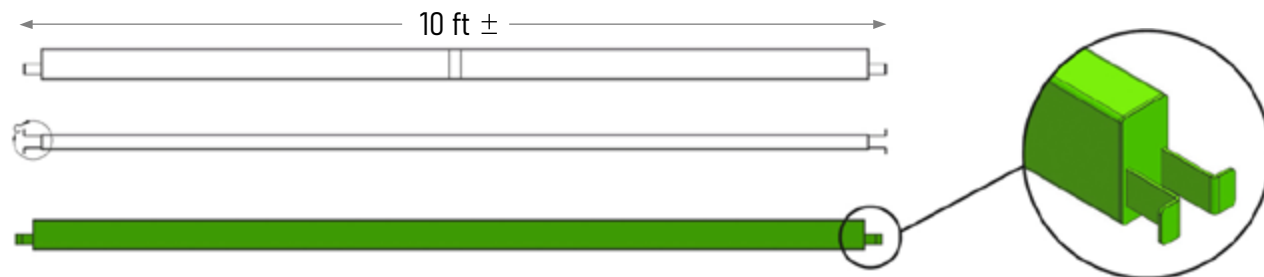

KEY FEATURES

- Electrostatic painted safety green or safety yellow for added safety and visibility
- Toe boards can be easily installed in just minutes
- Toe Boards fit perfectly into the base
- Available colors: ■ Safety Green ■ Safety Yellow ■ Hot Dip Galvanized



FRONTLINE SAFETY GUARDRAIL SYSTEM

SCAN QR CODE TO WATCH VIDEO

GUARDRAIL BASE LIFTING DOLLY

GUBDO



KEY FEATURES

- EPDM ergonomic grips for easy transporting and handling
- Flat free tires for long lasting use on all the different substrates
- Made out of quality material featuring ASTM rated steel with electrostatic safety colored paint
- Lightweight so carry it and use it from jobsite to jobsite

The Frontline base dolly is designed to help users move the bases easily and with very little effort! This helps the worker be more productive and helps reduce lifting injuries for better ergonomics when transporting the bases throughout the jobsite or for long distances.

Available colors: ■ Safety Green ■ Safety Yellow



GUARDRAIL CART

GUSCART

Introducing the Frontline Guardrail Cart – your ultimate solution for effortless and ergonomic transport of guardrails and bases on the job site.

Crafted with innovation, this cart streamlines your workflow by accommodating up to 10 rails and 11 bases simultaneously. Its user-friendly design ensures ease of use, allowing you to navigate through job sites with utmost convenience.

Equipped with a spacious auxiliary storage unit, the Frontline Guardrail Cart not only transports your materials efficiently but also offers convenient storage for tools and miscellaneous items essential for your tasks.

Made with high-quality materials, this cart guarantees durability and longevity, standing the test of time in demanding work environments.



MANHOLE GUARDRAIL

GUM



Available colors: ■ Safety Green ■ Safety Yellow

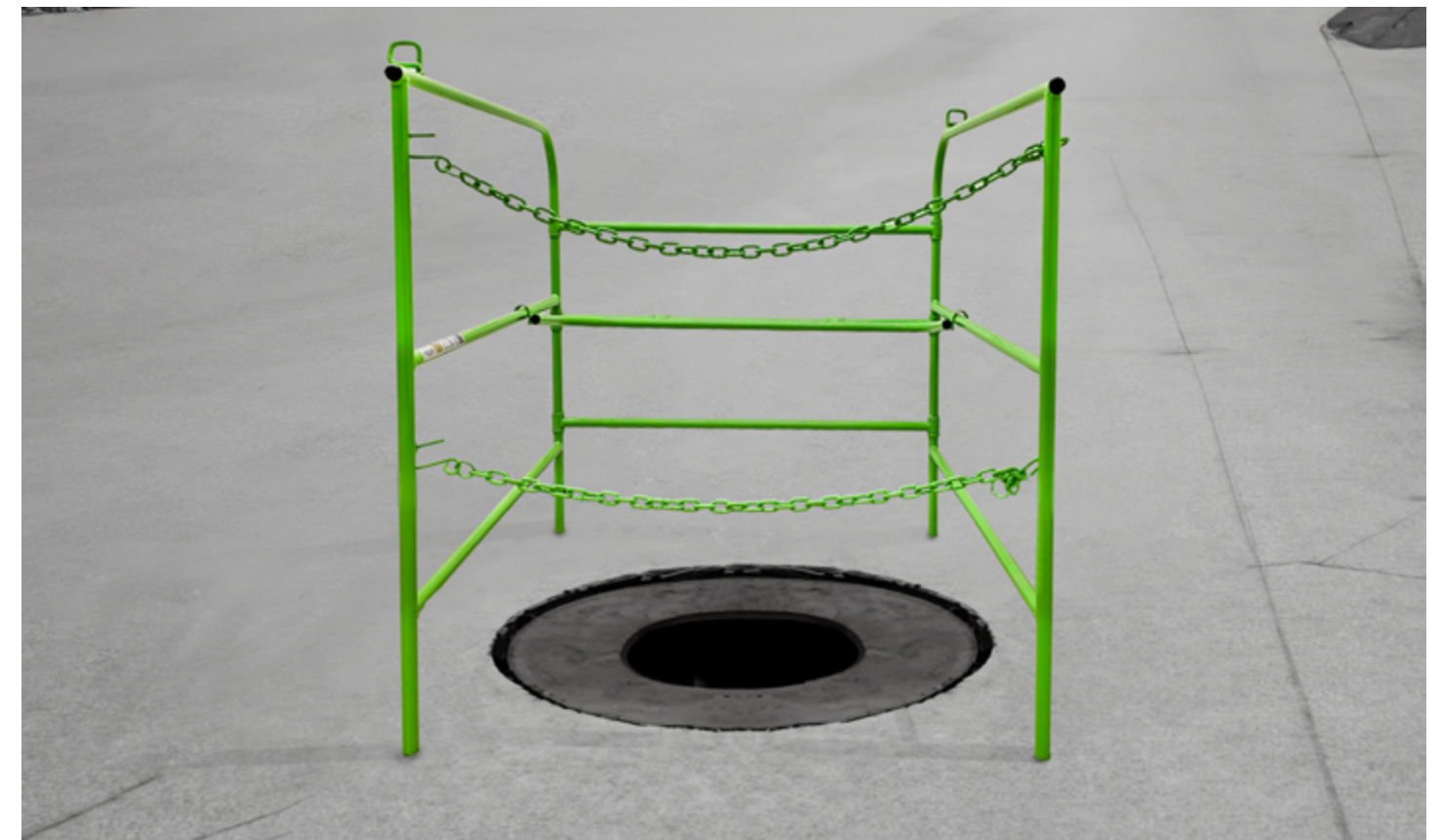

The Frontline manhole guardrail is used for confined space entries that require a temporary barrier to prevent accidental fall through or to prevent each employee working in the space from foreign objects entering the space as described by OSHA.

AVAILABLE DIMENSIONS

32" X 32" GUM32 **42" X 42"** GUM42

KEY FEATURES

- For manhole use for confined spaces to protect those working inside and outside the work area
- Collapsible product design makes it easy to store and transport
- Powder coated safety green for added visibility and safety
- Conveniently sets-up in seconds, no tools required
- Includes two chains for added safety



FRONTLINE[®]
FALL PROTECTION

WWW.FRONTLINEFALL.COM

INFO@FRONTLINEFALL.COM